



# VIGOR PRECISION LTD 力嘉精密有限公司

Flat A1, A4-A8, 8/F, Block A, Texaco Road Industrial Centre, 256-264 Texaco Road, Tsuen Wan Hong Kong  
 香港荃灣德士古道256-264號德士古道工業中心A坐8字樓A1, A4-A8 室

Tel電話: (852)2407 5498(8 lines) Fax傳真: (852) 2407 3148

E-mail電子郵件: enquiry@vigorprecision.com.hk Web Site網址: http://www.vigorprecision.com.hk

## BO-P17 WITH 1012FE MOTOR (planetary gearbox)

OUTPUT : 0.05W~0.5W (APPROX)

WEIGHT : 4g

Typical applications : Consumer Electronic Products

Toys and Models

Personal Care Product

Office Automation Equipments



Model	Gear ratio	Voltage (V)	No Load		Max Efficiency (%)			Max Output (W)			Stall	
			Speed (rpm)	Current (A)	Speed (rpm)	Current (A)	Torque (kgf.cm)	Speed (rpm)	Current (A)	Torque (kgf.cm)	Torque (kgf.cm)	Current (A)
BP17-171012FE-10D-4.5	171	4.5	115	0.08	84	0.12	0.10	58	0.15	0.18	0.36	0.27
BP17-171012FE-10D-6.0	171	6.0	153	0.11	112	0.16	0.13	77	0.20	0.24	0.48	0.38

For Reference Only

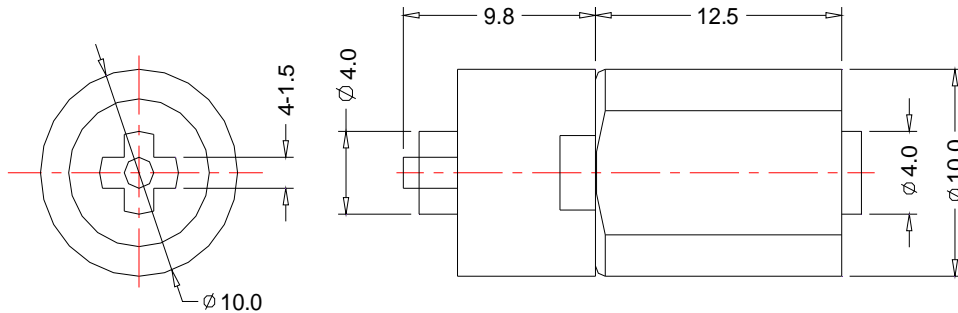

Unit:mm

BP17-171012FE-10D-4.5 4.5V

BP17-171012FE-10D-6.0 6.0V

